

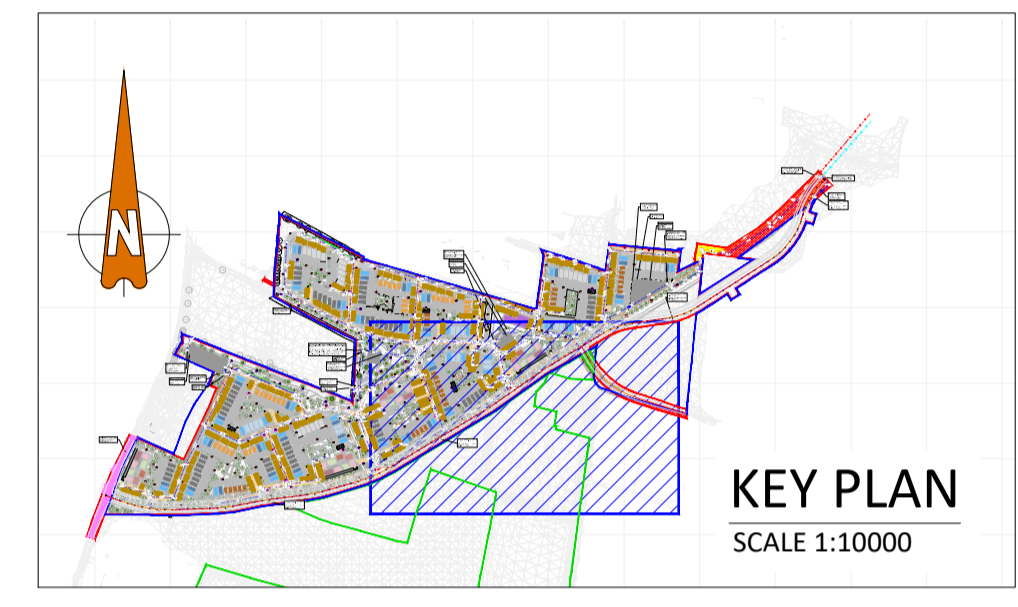

**LEGEND:**

PROPOSED SURFACE DRAINAGE (UPVC TWINWALL OR SIMILAR APPROVED)	
PROPOSED FILTER DRAIN (PERFORATED UPVC TWINWALL OR SIMILAR APPROVED)	
PROPOSED SURFACE DRAINAGE MANHOLE	
PROPOSED CONCRETE ATTENUATION TANK	
PROPOSED PERVIOUS PAVING	
PROPOSED OIL/PETROL SEPARATOR	
PROPOSED WASTEWATER DRAINAGE (UPVC S8 OR SIMILAR APPROVED)	
PROPOSED WASTEWATER DRAINAGE MANHOLE	
EXISTING SURFACE WATER DRAINAGE (FROM TOPO SURVEY RECORDS)	
EXISTING SURFACE WATER DRAINAGE MANHOLE (FROM TOPO SURVEY RECORDS)	
EXISTING WASTEWATER DRAINAGE (FROM TOPO SURVEY RECORDS)	
EXISTING WASTEWATER DRAINAGE MANHOLE (FROM TOPO SURVEY RECORDS)	
PROPOSED PERVIOUS PAVING	
DETENTION BASIN TOP OF SLOPE	
DETENTION BASIN BOTTOM OF SLOPE	



- GENERAL NOTES:**
- ALL NOTED LEVELS ARE TO ORDNANCE DATUM, MAIN HEAD.
  - REFER TO ARCHITECT'S LAYOUT FOR ALL SET-OUT INFORMATION.
  - REFER TO ARCHITECT / LANDSCAPE ARCHITECT'S DESIGN DRAWINGS FOR DETAILS OF PROPOSED SURFACE FINISHES AND LANDSCAPING.
  - REFER TO ARCHITECT DRAWINGS FOR DETAILS OF PRIVATE DRAINAGE.
  - ALL SURFACE WATER DRAINAGE IS TO BE INSTALLED IN ACCORDANCE WITH THE GREATER DUBLIN REGION CODE OF PRACTICE FOR DRAINAGE WORKS, THE BUILDING REGULATIONS PART H AND THE SITE DEVELOPMENT SPECIFICATION.
  - ALL CAR PARK DRAINAGE IS TO BE INSTALLED IN ACCORDANCE WITH THE GREATER DUBLIN REGION CODE OF PRACTICE FOR DRAINAGE WORKS, THE BUILDING REGULATIONS PART H AND THE SITE DEVELOPMENT SPECIFICATION.
  - ALL WASTEWATER DRAINAGE IS TO BE INSTALLED IN ACCORDANCE WITH THE IRISH WATER CODE OF PRACTICE FOR WASTEWATER INFRASTRUCTURE (REVISION 2 - JULY 2020), THE BUILDING REGULATIONS PART H AND THE SITE DEVELOPMENT SPECIFICATION.
  - ALL DRAINAGE COVER LEVELS ARE TO BE COORDINATED WITH PROPOSED ROAD DESIGN LEVELS AND ARCHITECT/LANDSCAPE ARCHITECT'S PROPOSED FINISH LEVELS.
  - ALL BASEMENT CHAMBER COVERS TO BE DOUBLE SEALED, AND CLASSIFICATION D400 LOADING WHERE LOCATED IN VEHICULAR AREAS.
  - ALL CONNECTIONS TO NEW DRAINAGE NETWORKS ARE TO BE MADE AT AN ANGLE OF 90° OR IN THE DIRECTION OF FLOW.
  - REFER TO ARCHITECT AND M/E ENGINEERING DESIGN DRAWINGS FOR CONFIRMATION OF LOCATION AND SPECIFICATION OF FLOOR GULLIES.
  - REFER TO M/E ENGINEERING DESIGN FOR CONFIRMATION OF WASTE AND SANITARY POP-UP/OUTLET LOCATIONS.
  - THE CONTRACTOR IS TO VERIFY INVERT LEVEL AT PROPOSED CONNECTION TO EXISTING SEWERS, PRIOR TO ANY OTHER WORKS BEING CARRIED OUT, AND MAKE ANY DISCREPANCIES KNOWN TO THE ENGINEER.
  - THE CONTRACTOR IS RESPONSIBLE FOR CONFIRMATION OF PRESENCE ALL EXISTING UTILITIES, IF ANY, ALONG ROUTE OF PROPOSED DRAINAGE NETWORKS - BY INTRUSIVE INVESTIGATION OR EQUAL.
  - EXISTING PUBLIC SEWER TO BE JET CLEANED AND CCTV SURVEYED PRIOR TO, AND AFTER PROPOSED CONNECTIONS FROM NEW NETWORK.
  - ALL NEW DRAINAGE INFRASTRUCTURE TO BE JET CLEANED AND CCTV SURVEYED, WITH ANY NOTED DEFECTS REMEDIATED, ON COMPLETION OF WORKS, TO THE SATISFACTION OF THE LOCAL AUTHORITY.
  - WHERE MANHOLE COVERS ARE TO BE LOCATED IN SOFT LANDSCAPED/GRASS AREAS; TO ENSURE THAT MANHOLE COVERS ARE IDENTIFIABLE, ACCESSIBLE AND WILL NOT BECOME OVERGROWN, COVERS ARE TO BE SURROUNDED BY A CONCRETE PLINTH, 200MM ALL ROUND AND 100MM DEEP FORMED WITH C20/25 CONCRETE, 20MM AGGREGATE SIZE, BEDDED IN CLAUSE 804 MATERIAL.
  - WHERE PROXIMITY OF THE TREE LINE AND THE PROPOSED SEWER LINES ARE NOT IN COMPLIANCE WITH THE RESTRICTION ON PLANTING ADJACENT TO WASTEWATER INFRASTRUCTURE AS PER DETAIL STD-WW-06 AND STD-WW-06A, ROOT BARRIERS TO BE PROVIDED (GREENLEAF IRELAND OR EQUIVALENT APPROVED)

PROPOSED FLOW CONTROL CHAMBER WITH PENSTOCK AT INLET  
HYDROBRAKE OR SIMILAR APPROVED  
DESIGN HEAD = 1.20 m  
MAXIMUM FLOW RATE = 3 l/s

DRAINAGE PIPES AND MANHOLES SCHEDULE PROVIDED ON THE DRAWING L308-OCSC-XX-DR-C-0505

**PLANNING DRAWING.**  
**NOT FOR CONSTRUCTION.**  
ALL LEVELS GIVEN ARE RELATIVE TO ORDNANCE DATUM.  
THIS DRAWING HAS BEEN ISSUED FOR INFORMATION PURPOSES ONLY AND MUST NOT BE USED FOR CONSTRUCTION UNDER ANY CIRCUMSTANCES

ORDNANCE SURVEY OF IRELAND LICENCE NO. EN0000819 © GOVERNMENT OF IRELAND

- FOR SETTING OUT REFER TO ARCHITECT'S DRAWINGS.
- THIS DRAWING TO BE READ IN CONJUNCTION WITH ALL OTHER ARCHITECTURAL AND ENGINEERING DRAWINGS AND ALL OTHER RELEVANT DRAWINGS AND SPECIFICATIONS.
- DO NOT SCALE THIS DRAWING. USE FIGURED DIMENSIONS ONLY.
- NO PART OF THIS DOCUMENT MAY BE REPRODUCED OR TRANSMITTED IN ANY FORM OR STORED IN ANY RETRIEVAL SYSTEM OF ANY NATURE WITHOUT THE WRITTEN PERMISSION OF O'CONNOR SUTTON CRONIN AS COPYRIGHT HOLDER EXCEPT AS AGREED FOR USE ON THE PROJECT FOR WHICH THE DOCUMENT WAS ORIGINALLY ISSUED.

Rev No.	Date	Revision Note	Drn by	Chkd by	Rev No.	Date	Revision Note	Drn by	Chkd by
P01	23/07/21	SUITABLE FOR INFORMATION	RM	DR					
P02	17/09/21	SUITABLE FOR INFORMATION	RM	DR					
P03	04/10/21	SUITABLE FOR STAGE APPROVAL	RM	DR					
P04	22/10/21	SUITABLE FOR STAGE APPROVAL	RM	DR					
P05	25/04/22	SUITABLE FOR STAGE APPROVAL	ZB	MK					
P06	17/05/22	DRAINAGE LAYOUT REVISED	ZB	MK					

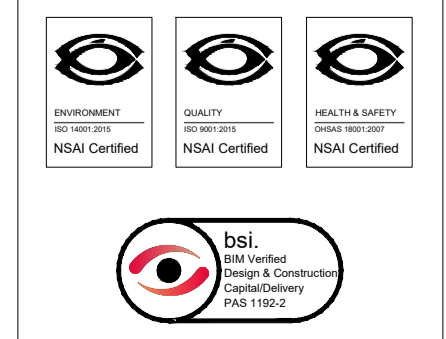

Head Office,  
9 Prussia Street,  
Dublin 7,  
D07 KT57

TEL +353 (0)1 8682000

e: [contactus@ocsc.ie](mailto:contactus@ocsc.ie)  
w: [www.ocsc.ie](http://www.ocsc.ie)

Dublin | London | Belfast | Galway | Cork | Birmingham



Client: **BE0 PROPERTIES LIMITED**  
Project: **RATOATH SOUTH SHD**

Title: **PROPOSED DRAINAGE LAYOUT SHEET 3 OF 4**

Code	Originator	Zone	Level	Type	Role	Number	Status	Revision
L308	OCSC	XX	XX	DR	C	0503	S4	P06

Date: NOV'20 Scale: 1:500 @ A1 Drn by:RM Chkd by:DR Aprvd by:AH